

Drain: CAREY COMMONS DRAIN **Drain #:** 306
Improvement/Arm: CAREY COMMONS - SECTION 2
Operator: JDH **Date:** 11-6-03
Drain Classification: Urban/Rural **Year Installed:** 1999

GIS Drain Input Checklist

- Pull Source Documents for Scanning JJA 11-6
- Digitize & Attribute Tile Drains N/A
- Digitize & Attribute Storm Drains JJA 11-6
- Digitize & Attribute SSD JJA 11-6
- Digitize & Attribute Open Ditch JJA 11-6
- Stamp Plans JJA 11-6
- Sum drain lengths & Validate JJA 11-6
- Enter Improvements into Posse JJA 11-6
- Enter Drain Age into Posse _____
- Sum drain length for Watershed in Posse _____
- Check Database entries for errors JJA 11-6

Gasb 34 Footages for Historical Cost
Drain Length Log

Drain-Improvement: CAREY COMMONS - SECTION 2

Drain Type:	Size:	Length <small>SURVEYOR'S REPORT</small>	Length <small>(DB Query)</small>	Length <small>Reconcile</small>	If Applicable	
					Price:	Cost:
SSO	6"	1616'	1757'	+141'		
RCP	12"	129'	129'	Ø		
	15"	633'	633'	Ø		
	18"	28'	28'	Ø		
	21"	447'	448'	+1'		
	24"	328'	328'	Ø		
	27"	27'	27'	Ø		
OPEN DITCH		1280'	1280'	Ø		

Sum: 4488' 4630' +142'

Final Report: _____

Comments:

AS QUITS SHOW MORE LENGTH FOR SSO THAN THE SURVEYOR'S REPORT.
AS QUITS SHOW SPAN BETWEEN STR. 822 AND EXISTING MANHOLE AS LENGTH OF 221', NOT 220' AS
SHOWN ON SURVEYOR'S REPORT

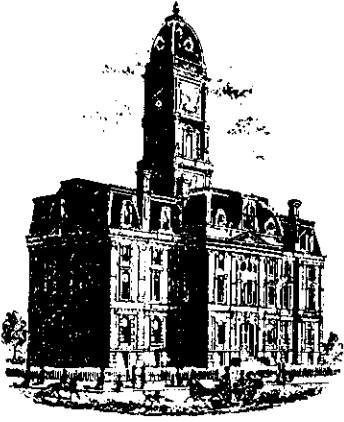

SURVEYOR'S OFFICE

Hamilton County

Kenton C. Ward, Surveyor

Phone (317) 776-8495

Fax (317) 776-9628

Suite 146

One Hamilton County Square

Noblesville, Indiana 46060-2230

To: Hamilton County Drainage Board

July 30, 1999

Re: Carey Commons Drain, Section 2 Arm

Attached is a petition, non-enforcement request, plans, calculations, quantity summary and assessment roll for the Section 2 arm, Carey Commons Drain. I have reviewed the submittals and petition and have found each to be in proper form.

I have made a personal inspection of the land described in the petition. Upon doing so, I believe that the drain is practicable; will improve public health; benefit a public highway and be of public utility; and that the costs, damages and expenses of the proposed drain will probably be less than the benefits accruing to the owners of land likely to be benefited. The drain will consist of the following:

6" SSD	1,440 ft	15" RCP	658 ft	24" RCP	333 ft
Open Ditch	1,280 ft	18" RCP	28 ft	27" RCP	30 ft
12" RCP	131 ft	21" RCP	447 ft		

The total length of the drain will be 4,347 feet.

The retention pond (lake) located in Common Area B and Common Area D is not to be considered part of the regulated drain. Only the inlet and outlet will be maintained as part of the regulated drain. The maintenance of the pond (lake) will be the responsibility of the Homeowners Association. The Board will however, retain jurisdiction for ensuring the storage volume for which the lake was designed will be retained. Thereby, allowing no fill or easement encroachments.

The subsurface drains (SSD) to be part of the regulated drain are those located under curbs. Only the main SSD lines, which are located within the right of way, are to be maintained as regulated drain. Laterals for individual lots will not be considered part of the regulated drain.

The open ditch listed above includes the open ditch between structure 824 and 825 in Common Area Block C. It also includes the offsite outlet between STR 804 and the Wheeler & Beals Drain. This is the South side ditch for the old Indiana Central Rail Road now known as the White River, Noblesville, and Westfield Rail Road.

I have reviewed the plans and believe the drain will benefit each lot equally. Therefore, I recommend each lot be assessed equally. I also believe that no damages will result to landowners by the construction of this drain. I recommend a maintenance assessment of \$50.00 per lot, \$5.00 per acre for roadways, with a \$50.00 minimum. With this assessment the total annual assessment for this drain/this section will be \$1,582.05.

Parcels assessed for this drain may be assessed for the Wheeler & Beals or Cool Creek Drains at sometime in the future.

I believe this proposed drain meets the requirements for Urban Drain Classification as set out in IC 36-9-27-67 - 69. Therefore, this drain shall be designated as an Urban Drain.

I recommend that upon approval of the above proposed drain that the Board also approve the attached non-enforcement request. This request is for the reduction of the regulated drain easement to those easement widths as shown on the secondary plat for Carey Commons, Section 2 as recorded in the office of the Hamilton County Recorder.

I recommend the Board set a hearing for this proposed drain for September 27, 1999.

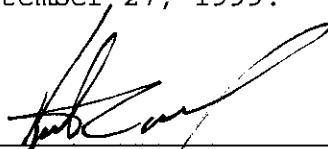

Kenton C. Ward
Hamilton County Surveyor

KCW/llm

STATE OF INDIANA)
)
COUNTY OF HAMILTON)

TO: HAMILTON COUNTY DRAINAGE BOARD
% Hamilton County Surveyor, Courthouse, Noblesville, IN 46060

In the matter of CAREY COMMONS Subdivision,
Section II Drain Petition.

Petitioner is the owner of all lots in the land affected by the proposed new regulated drain. The drainage will affect various lots in CAREY COMMONS SEC. II, a subdivision in Hamilton County, Indiana. The general route of such drainage shall be in existing easements and along public roads as shown in the plans on file in the Surveyor's Office.

Petitioner believes that the cost, damages and expenses of the proposed improvement will be less than the benefits which will result to the owners of the land likely to be benefited thereby. Petitioner believes the proposed improvements will:

- (a) improve public health
- (b) benefit a public street
- (c) be of public utility

Petitioner agrees to pay the cost of construction of the drainage system and requests periodic maintenance assessments by the Board thereafter.

The Petitioner also agrees to the following:

1. To provide the Drainage Board a Performance Bond for the portion of the drainage system which will be made a regulated drain. The bond will be in the amount of 100% of the Engineers estimate. The bond will be in effect until construction of 100% of the system is completed and so certified by the Engineer.
2. The Petitioner shall retain an Engineer throughout the construction phase. At completion of the project the Petitioner's Engineer shall certify that the drainage system which is to be maintained as a regulated drain has been constructed as per construction plans.

3. The Petitioner agrees to request in writing to the County Surveyor any changes from the approved plan and must receive written authorization from the County Surveyor prior to implementation of the change. All changes shall be documented and given to the Surveyor to be placed in the Drain File.
4. The Petitioner shall instruct his Engineer to provide a reproducible print on a 24" x 36" mylar of the final design of the Drainage System. This shall be submitted to the County Surveyor prior to the release of the Performance Bond.
5. The Petitioner shall comply with the Erosion Control Plan as as specified on the construction plans. Failure to comply with the Erosion Control Plan shall be determined by the Board as being an obstruction to the drainage system. The County Surveyor shall immediately install or repair the needed measures at Petitioners cost as per IC 36-9-27-46.

The Petitioner further requests that the Drain be classified as an Urban Drain.

Signed MANAGING MEMBER

SHELDON S. PHELPS
Printed Name

Signed

Printed Name

RECORDED OWNER(S) OF LAND INVOLVED

DATE _____

FINDINGS AND ORDER
CONCERNING THE MAINTENANCE OF THE
Carey Commons Drain, Section 2

On this *27th day of September 1999*, the Hamilton County Drainage Board has held a hearing on the Maintenance Report and Schedule of Assessments of the *Carey Commons Drain, Section 2*.

Evidence has been heard. Objections were presented and considered. The Board then adopted the original/amended Schedule of Assessments. The Board now finds that the annual maintenance assessment will be less than the benefits to the landowners and issues this order declaring that this Maintenance Fund be established.

HAMILTON COUNTY DRAINAGE BOARD

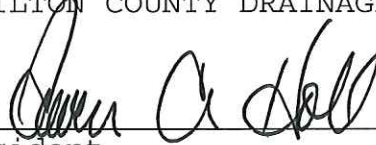

President



Member



Member

Attest: 



CONSULTING ENGINEERS
LAND SURVEYORS

R.M. Stoepelwerth, PE, PLS • David J. Stoepelwerth, PE, PLS • Curtis C. Huff, PLS • Dennis D. Olmstead, PLS • Jeffory W. Darling, PLS

March 24, 1999

Hamilton County Surveyor's Office
One Hamilton County Square
Noblesville, IN 46060

Attention: Kent Ward

Re: Carey Commons, Phase Two

Dear Mr. Ward:

The following is an engineer's estimate for the Carey Commons, Phase Two.

Street Monuments	\$200.00
Storm Sewer	\$52,804.00
Sub-surface drains	\$8,897.00
Erosion control	<u>\$5016.00</u>
Total	\$66,917.00

If you have any questions concerning these amounts please contact me at 849-5935.

Very truly yours,

STOEPPELWERTH & ASSOCIATES, INC.

David J. Stoepelwerth, P.E., P.L.S.

DJS98/28472P2



P.O. Box 1990
Noblesville, Indiana 46061
(317) 773-0800 ■ FAX (317) 776-6960

FILE **FILE COPY**

MAR 24 1999

OFFICE OF HAMILTON COUNTY SURVEYOR

IRREVOCABLE STANDBY LETTER OF CREDIT

Irrevocable Letter of Credit No. 216

March 16, 1999

BENEFICIARY:

Hamilton County Board of Commissioners
One Hamilton County Square
Noblesville, IN 46060

FOR THE ACCOUNT OF:

Carey Development LLC
9011 Bradwell Place, Suite 103
Fishers, IN 46038

Attention: Kent Ward

We hereby establish our Irrevocable Standby Letter of Credit in your favor, for the account indicated above, for the sum or sums not exceeding an aggregate amount of USD\$61,701.00 (Sixty-One Thousand, Seven Hundred One Dollars and No Cents).

Funds are available for draft(s) at sight drawn on Community Bank, Noblesville, IN 46060.

Drafts are to be accompanied by:

1. The original of this Irrevocable Letter of Credit No. 216.
2. Beneficiary's signed certificate stating that Carey Development LLC has failed to complete Storm Sewers (\$52,804.00) and Sub-surface Drains (\$8,897.00) in Carey Commons subdivision, Section II.

We engage with you that all draft(s) under and in accordance with the terms of this Letter of Credit shall be duly honored upon presentation.

All drafts drawn under this Letter of Credit are to be endorsed hereon and shall bear the clause: "Drawn under Community Bank, Noblesville, Indiana Irrevocable Letter of Credit No. 216." Drafts drawn under this letter of credit must be presented on or prior to the expiration date of March 16, 2000.

Except as otherwise expressly stated herein, this credit is subject to the Uniform Customs and Practice for Documentary Credits (1993 Revision), International Chamber of Commerce, Publication No. 500.

Very truly yours,

Community Bank

Larry Riggs
Senior Vice President

**BOARD OF COMMISSIONERS
OF THE COUNTY OF HAMILTON**

DATE _____

**ATTEST: _____
HAMILTON COUNTY AUDITOR**

RELEASED 10-25-99

CAREY COMMONS, SECTION 2
CERTIFICATE OF COMPLETION AND COMPLIANCE

Address of premises on which land
alteration was accomplished 171ST Street & Carey Road

Inspection Date(s): _____ Permit No. _____

Relative to plans prepared by: Stooppelwerth & Associates, Inc.
on January 20, 1998 .

I hereby certify that:

To the best of my knowledge, information and belief such land alteration has been
performed and completed in conformity with the improved plan, except _____

Signature Jeffery Darling Date: 9/23/99

Type Name: Jeffery W. Darling Phone: (317) 849-5935

Business Address: 9940 Allisonville Road, Fishers, IN 46038

Surv. X Engr. _____ Arch. _____ Indiana Registration No. 900017

(SEAL)



Metes/28472C&C



SURVEYOR'S OFFICE

Hamilton County

Kenton C. Ward, Surveyor

Phone (317) 776-8495

Fax (317) 776-9628

Suite 188

One Hamilton County Square

Noblesville, Indiana 46060-2230

To: Hamilton County Drainage Board

July 7, 2003

Re: Carey Commons Drain: Sec. 2 Arm

Attached are as-builts, certificate of completion & compliance, and other information for Carey Commons Sec. 2. An inspection of the drainage facilities for this section has been made and the facilities were found to be complete and acceptable.

During construction, changes were made to the drain, which will alter the plans submitted with my report for this drain-dated July 30, 1999. The report was approved by the Board at the hearing held September 27, 1999. (See Drainage Board Minutes Book 5, Pages 220-222) The changes are as follows:

Structure:	T.C.:	I.E.:	Pipe:	Length:	Original Plans:	Difference:
804		855.93				
802	861.58	855.99	27	27	30	-3
802	861.58	855.99				
801	861.5	856.5	24	213	216	-3
801	861.5	856.5				
800		856.53	24	28	27	1
803		856.53				
802	861.58	855.99	12	15	18	-3
Existing RCP		857.85				
808	860.11	856.87	21	227		
808	860.11	856.87				
807		856.4	24	87	90	-3
833		857.05				
832	860.46	857.31	15	51	53	-2
832	860.46	857.31				
828	860.36	858.15	15	245	246	-1
828	860.36	858.15				
827	864.12	860.86	12	82	83	-1
806	860.87	857.84				
805		856.95	15	48	52	-4
808	860.11	856.87				

817	862.65	858.72	15	148	150	-2
817	862.65	858.72				
818	862.67	859.01	12	32	30	2
825		861.41				
826		861.89	15	105	113	-8
824		860.87				
823	863.72	860.79	15	36	44	-8
823	863.72	860.79				
822	863.76	860.58	18	28		
822	863.76	860.58				
Existing Manhole	863.44	860.34	21	220	221	-1

6" SSD Streets:

FUTCH WAY	491
SHADOAN WAY	317
x2	

Total: 1616

Open Drain:	1280
--------------------	-------------

RCP Pipe Totals:

12	129
15	633
18	28
21	447
24	328
27	27
Total	1592

The length of the drain due to the changes described above is now **4,488 feet**.

The non-enforcement was approved by the Board at its meeting on September 27, 1999 and recorded under instrument #200000004040.

The letters of credit from Community Bank, numbers 214 and 216; dated March 16, 1999; in the amounts of \$5,016 and \$52,804 ; were released June 26, 2000 and October 25, 1999.

I recommend the Board approve the drain's construction as complete and acceptable.

Sincerely,

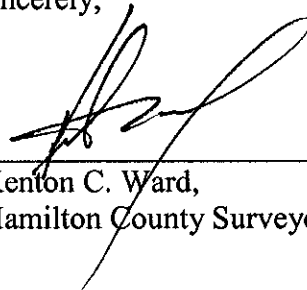

Kenton C. Ward,
Hamilton County Surveyor

KCW/slm



SURVEYOR'S OFFICE

Hamilton County

Kenton C. Ward, Surveyor
 Phone (317) 776-8495
 Fax (317) 776-9628

Suite 188
 One Hamilton County Square
 Noblesville, Indiana 46060-2230

To: Hamilton County Drainage Board

July 7, 2003

Re: Carey Commons Drain: Sec. 2 Arm

Attached are as-builts, certificate of completion & compliance, and other information for Carey Commons Sec. 2. An inspection of the drainage facilities for this section has been made and the facilities were found to be complete and acceptable.

During construction, changes were made to the drain, which will alter the plans submitted with my report for this drain-dated July 30, 1999. The report was approved by the Board at the hearing held September 27, 1999. (See Drainage Board Minutes Book 5, Pages 220-222) The changes are as follows:

Structure:	T.C.:	I.E.:	Pipe:	Length:	Original Plans:	Difference:
804		855.93				
802	861.58	855.99	27	27	30	-3
802	861.58	855.99				
801	861.5	856.5	24	213	216	-3
801	861.5	856.5				
800		856.53	24	28	27	1
803		856.53				
802	861.58	855.99	12	15	18	-3
Existing RCP		857.85				
808	860.11	856.87	21	227		
808	860.11	856.87				
807		856.4	24	87	90	-3
833		857.05				
832	860.46	857.31	15	51	53	-2
832	860.46	857.31				
828	860.36	858.15	15	245	246	-1
828	860.36	858.15				
827	864.12	860.86	12	82	83	-1
806	860.87	857.84				
805		856.95	15	48	52	-4
808	860.11	856.87				

817	862.65	858.72	15	148	150	-2
817	862.65	858.72				
818	862.67	859.01	12	32	30	2
825		861.41				
826		861.89	15	105	113	-8
824		860.87				
823	863.72	860.79	15	36	44	-8
823	863.72	860.79				
822	863.76	860.58	18	28		
822	863.76	860.58				
Existing Manhole	863.44	860.34	21	220	221	-1

6" SSD Streets:

FUTCH WAY	491
SHADOAN WAY	317
x2	

Total: 1616

Open Drain:	1280
--------------------	-------------

RCP Pipe Totals:

12	129
15	633
18	28
21	447
24	328
27	27
Total	1592

The length of the drain due to the changes described above is now **4,488 feet**.

The non-enforcement was approved by the Board at its meeting on September 27, 1999 and recorded under instrument #200000004040.

The letters of credit from Community Bank, numbers 214 and 216; dated March 16, 1999; in the amounts of \$5,016 and \$52,804 ; were released June 26, 2000 and October 25, 1999.

I recommend the Board approve the drain's construction as complete and acceptable.

Sincerely,

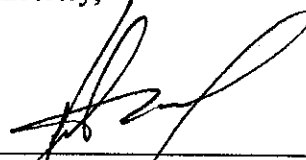

Kenton C. Ward,
Hamilton County Surveyor

KCW/slm

RECORD DRAWING

Jeffery W. Darling
 JEFFERY W. DARLING
 Registered Land Surveyor
 No. 900017

9/13/99
 DATE

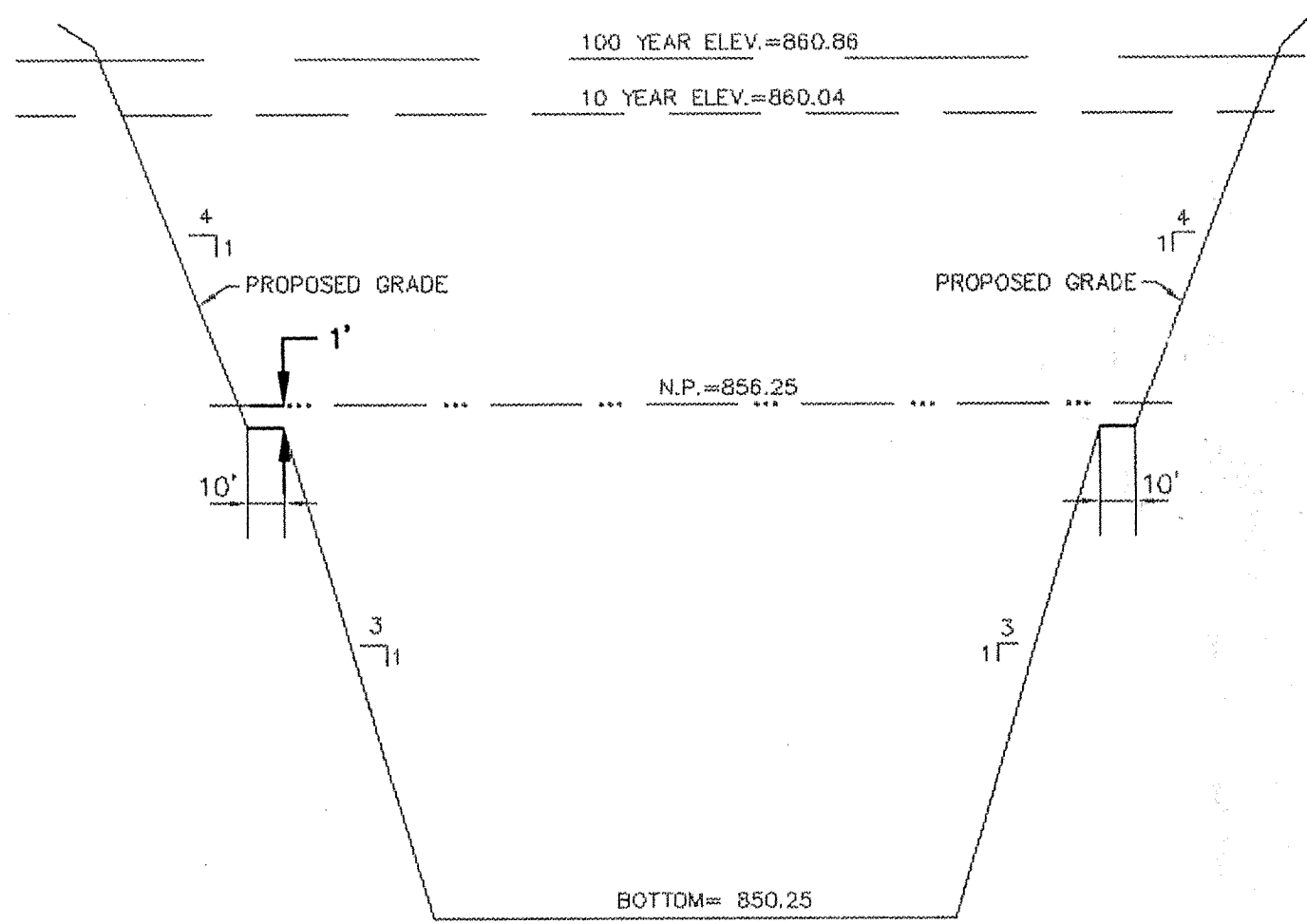

SECTION "A"-"A"
 NOT TO SCALE

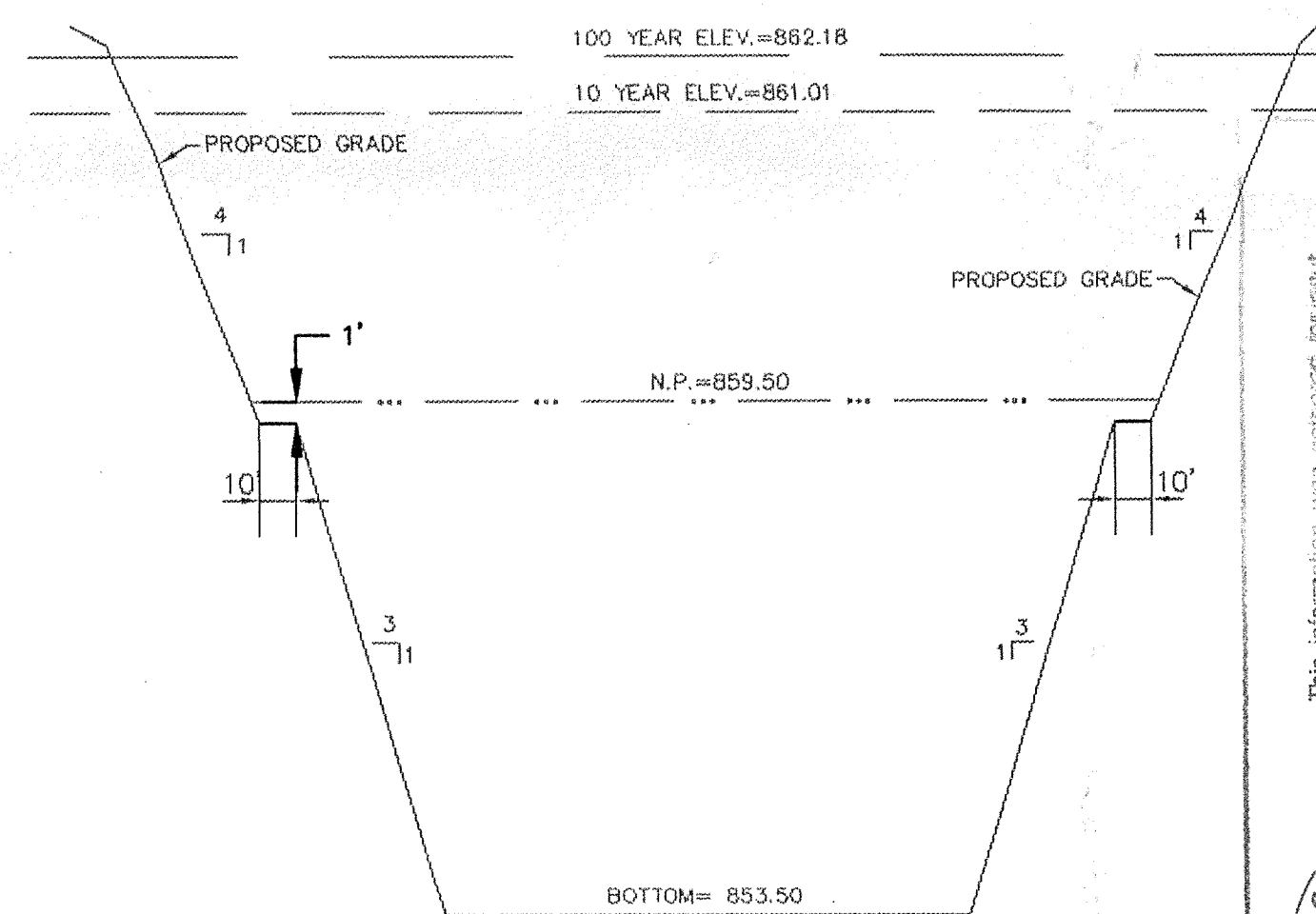

SECTION "B"-"B"
 NOT TO SCALE

EARTHWORK:

- EXCAVATION**
 - Excavated material that is suitable may be used for fill. All unsuitable material and all surplus excavated material not required shall be removed from the site.
 - Provide and place any additional fill material from offsite as may be necessary to produce the grades required on plans. Fill obtained from offsite shall be of quality as specified for fill herein and the source approved by the Developer. It will be the responsibility of the Contractor for any costs for fill needed.
- REMOVAL OF TREES**
 - All trees and stumps shall be removed from areas to be occupied by a road surface or structure area. Trees and stumps shall not be buried on site.
- PROTECTION OF TREES**
 - The Contractor shall, at the direction of the Developer, endeavor to save and protect trees of value and worth which do not impair construction of improvements as designed.
 - In the event cut or fill exceeds 0.5 foot over the root area, the Developer shall be consulted with respect to protective measure to be taken, if any, to preserve such trees.
- REMOVAL OF TOPSOIL**
 - All topsoil shall be removed from all areas beneath future pavements or building. Topsoil removal shall be to a minimum depth of 6 inches or to the depth indicated in the geotechnical report provided by the Developer to be excavated or filled. Topsoil should be stored at a location where it will not interfere with construction operations. The topsoil shall be free of debris and stones.
- UTILITIES**
 - Rules and regulation governing the respective utility shall be observed in executing all work under this section.
 - It shall be the responsibility of the Contractor to determine the location of existing underground utilities 2 working days prior to commencing work. For utility locations to be marked call Toll Free 1-800-382-5544 within Indiana or 1-800-428-5200 outside Indiana.
- SITE GRADING**
 - Do all cutting, filling, compacting of fills and rough grading required to bring entire project area to subgrade as shown on the drawing.
 - The tolerance for paved areas shall not exceed 0.04 feet above established subgrade. All other areas shall not exceed 0.10 feet plus or minus the established grade. Provide roundings at top and bottom of banks and other breaks in grade.
 - The Engineer shall be notified when the Contractor has reached the tolerance as stated above, so that field measurements and spot elevations can be verified by the Engineer. The Contractor shall not remove his equipment from the site until the Engineer has verified that the job meets the above tolerance.

FORM EARTHWRK

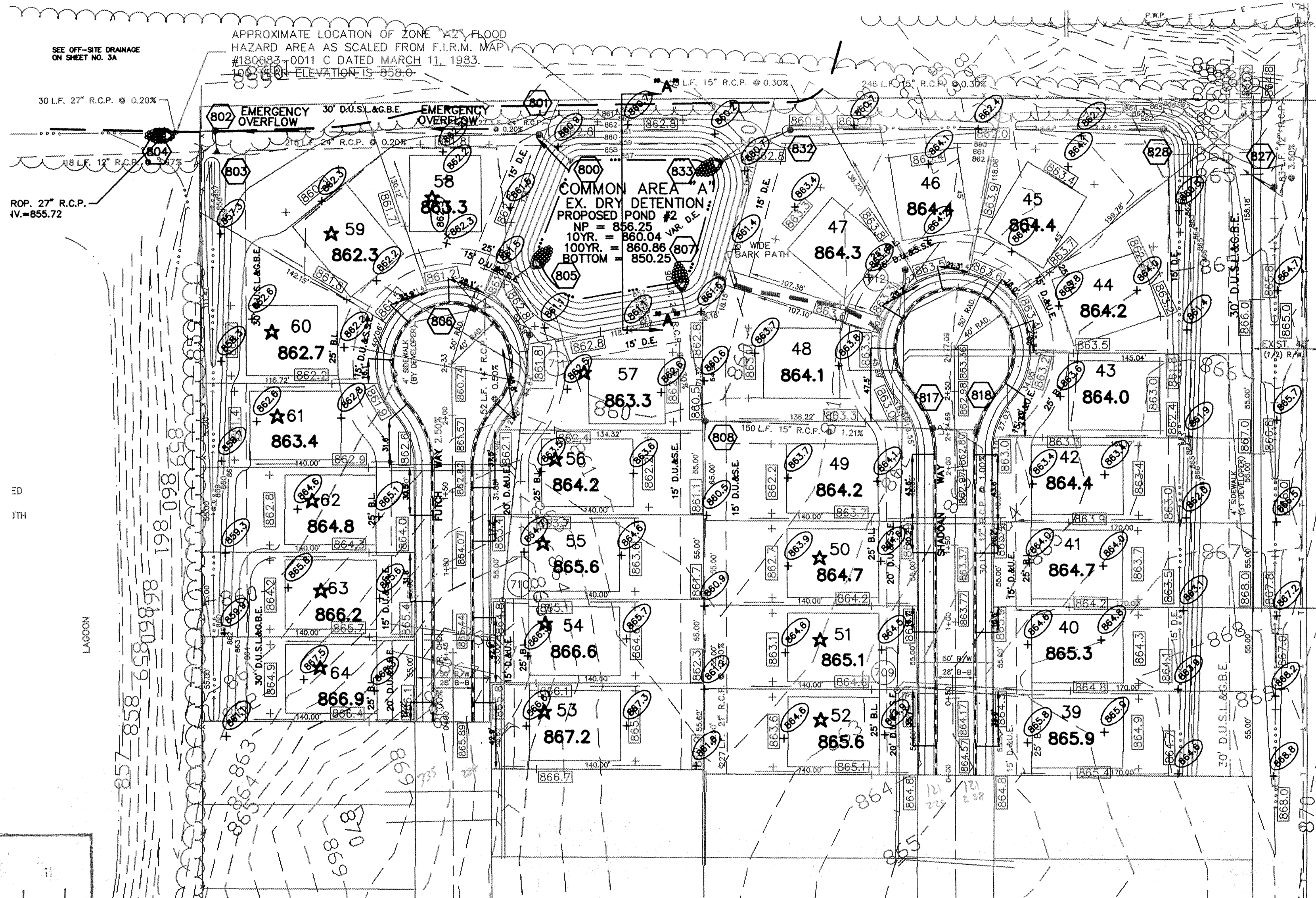

EXISTING PHASE ONE

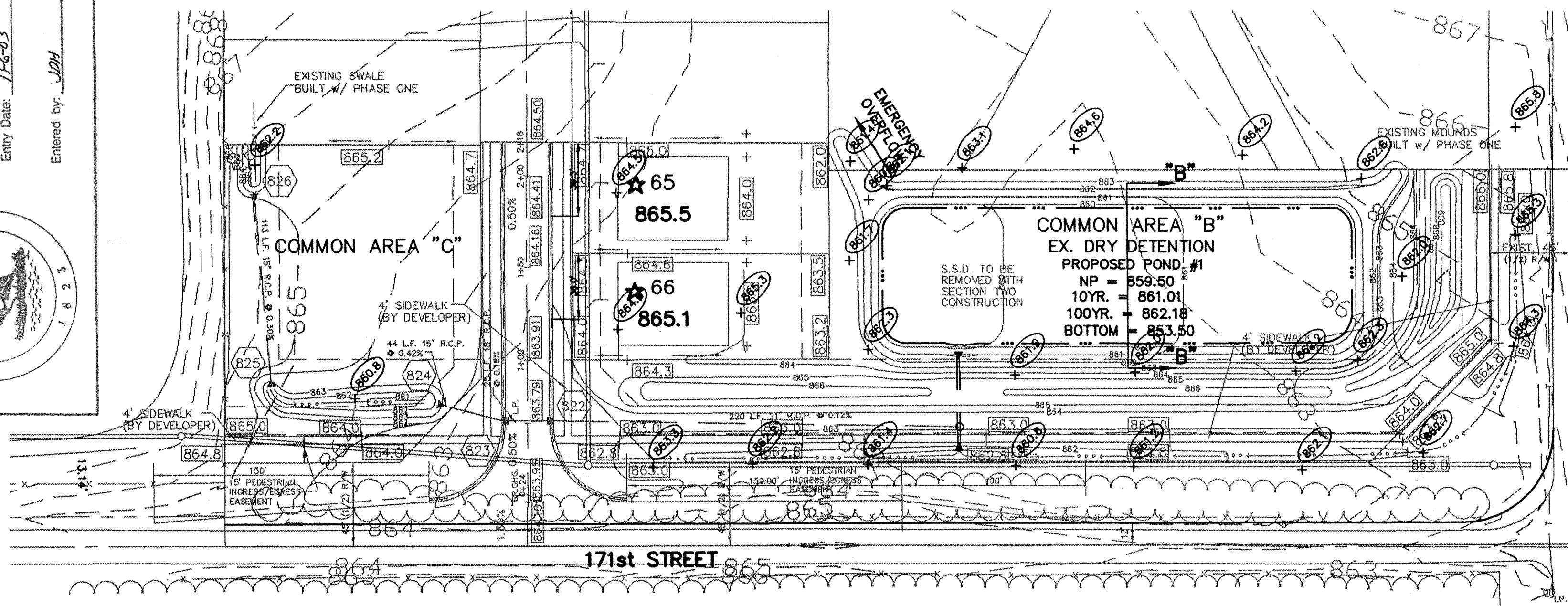

BENCHMARKS:

- A STATE DISK STAMPED 107 & SET IN THE TOP OF A CONCRETE POST AT THE N.E. CORNER OF PROPERTY. ELEV. = 869.41
- RAILROAD SPIKE SET IN S.E. SIDE OF 24" TREE CLUSTER, 1.5± ABOVE GROUND & 3.0± SOUTH OF NORTH PROPERTY LINE ALONG WEST PROPERTY LINE. ELEV. = 861.66
- RAILROAD SPIKE SET IN N.E. SIDE OF 24" TREE - 1.0± ABOVE GROUND & 500± NORTH OF SOUTH PROPERTY LINE ALONG WEST PROPERTY LINE. ELEV. = 871.27

"HOLEY MOLEY" SAYS:



1-800-382-5544
 CALL TOLL FREE
 1-800-428-5200
 FOR CALLS OUTSIDE OF INDIANA

CAUTION

LOCATION OF ALL EXISTING UNDERGROUND UTILITIES SHOWN ON THIS PLAN ARE BASED UPON ABOVE GROUND EVIDENCE (including, but not limited to, manholes, inlets, valves, & marks made upon the ground by others) AND ARE SPECULATIVE IN NATURE. THERE MAY ALSO BE OTHER EXISTING UNDERGROUND UTILITIES FOR WHICH THERE IS NO ABOVE GROUND EVIDENCE OR FOR WHICH NO ABOVE GROUND EVIDENCE WAS OBSERVED. THE EXACT LOCATIONS OF SAID EXISTING UNDERGROUND UTILITIES SHOULD BE VERIFIED BY THE CONTRACTOR PRIOR TO ANY AND ALL CONSTRUCTION.

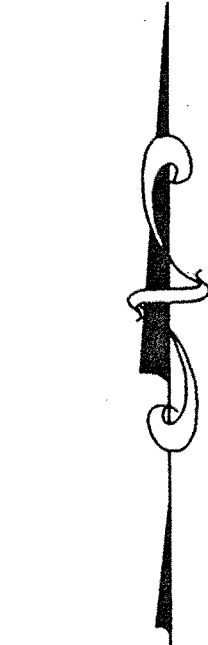

SCALE: 1" = 50'

LEGEND

- EXISTING CONTOUR
 - - - EXISTING SANITARY SEWER
 - - - EXISTING STORM SEWER
 - PROPOSED GRADE
 - - - PROPOSED CONTOUR
 - - - PROPOSED SANITARY SEWER
 - - - PROPOSED STORM SEWER
 - PROPOSED SWALE
 - PROPOSED 4' SIDEWALK (BY HOME BUILDER)
- 35 LOT NUMBER
 853.0 PAD ELEVATION
 PAD SIZE 50'x45'
 ★ DENOTES PADS OF 2'-0" OF FILL OR MORE
 4" SSD TO EA. LOT
 PROPOSED 6" UNDERDRAINS

STORM TABLE

Str. No.	Type	Tc/Rim	Inverts
800 *	CONCRETE END SECTION		857.00
801	MANHOLE	861.25	856.50
802	MANHOLE	850	855.75
803 *	CONCRETE END SECTION		856.44
804	CONCRETE END SECTION		855.72
805	CONCRETE END SECTION		857.00
806	CURB INLET	860.74	857.28
807	CONCRETE END SECTION		856.25
808	YARD INLET	860.50	857.08
809	CURB INLET	861.70	858.90
810	CURB INLET	862.70	859.20
811	CURB INLET	863.79	860.52
812	CURB INLET	863.79	860.57
813	CONCRETE END SECTION		860.75
825	CONCRETE END SECTION		861.56
826	YARD INLET	864.00	861.01
828	YARD INLET	860.50	858.10
832	YARD INLET	860.50	857.36
833	CONCRETE END SECTION		857.20

* TRASH GUARD TO BE INSTALLED

FILED
 SEP 24 1999
 OFFICE OF HAMILTON COUNTY SURVEYOR

DATE	BY	REVISIONS
1/20/98	DAV	
2/24/98	LAC	
4/22/98	BOG	
4/27/98	EDP	
5/25/98	BOG	
5/27/98	BOG	
5/27/98	BOG	

CERTIFIED: 1/20/98
 David J. Stoppelmeier
 REGISTERED PROFESSIONAL ENGINEER
 No. 19358
 STATE OF INDIANA

CONSULTING ENGINEERS - LAND SURVEYORS
 (317) 849-5935 1-800-728-6917 FAX: (317) 849-5942
 INDIANAPOLIS, INDIANA

FILED RECORD DRAWING

SITE DEVELOPMENT PLAN
 CAREY COMMONS PHASE TWO
 WESTFIELD, INDIANA

SHEET NO. 3
 OF 17 SHEETS
 JOB NO. 28472

CURB INLET TABLE

PIPE SIZE	STRUCTURES LESS THAN 48" FROM T/C TO INVERT	STRUCTURES GREATER THAN 48" FROM T/C TO INVERT	ANGLE AND QUALITY OF PIPES WILL REQUIRE SPECIAL DESIGN	STEPS REQUIRED	CURB CASTING *R-3501 N	CASTING *3501 TL & TR
12" to 18"	2'x2'		DESIGN APPROVAL	No	Yes	Yes
18" or 21"		MH/BOX	DESIGN APPROVAL	Yes	Yes	Yes
21" or 27"	2'x3'*		DESIGN APPROVAL	No	No	Yes
24" or LARGER	DESIGN APPROVAL		DESIGN APPROVAL	No	No	Yes
24" or LARGER		MH/BOX	DESIGN APPROVAL	Yes**	Yes	Yes

* PIPES NO LARGER THAN 18" CAN BE USED IN THE 2' SIDE OF THIS BOX
 ** INCOMING AND OUT GOING PIPES AFFECT STEPS IN THIS STRUCTURE

SPECIAL NOTE:
 STRUCTURES DEEPER THAN 48" FROM T/C TO INVERT WILL BE A M.H. OR A BOX WITH STEPS UNLESS SPECIAL DESIGN IS APPROVED.

SPECIAL NOTE:
 STRUCTURES WILL BE DESIGNED FOR MAXIMUM FLOW IN PIPES

SPECIAL NOTE:
 COUNTY MAY REQUIRE STEPS TO BE INSTALLED AFTER STRUCTURE IS SET, TO IMPROVE ACCESS.

RECORD DRAWING

SCALE: 1"=50' HOR.
 1"=5' VERT.

Jeffery W. Darling
 JEFFERY W. DARLING
 Registered Land Surveyor
 No. 900017
 DATE 9/13/99



REV.	DATE	BY	REVISIONS
1	1/20/98	DAVID J. STAPPERT	DATE
2	2/27/98	FRN	DATE
3	3/7/98	CK BY	DATE
4	3/7/98	SCALE	DATE
5	3/7/98	FILE	DATE
6	3/7/98	1"=50'	DATE
7	3/7/98	1"=50'	DATE

SCALE: 1"=50' HOR.
 1"=5' VERT.

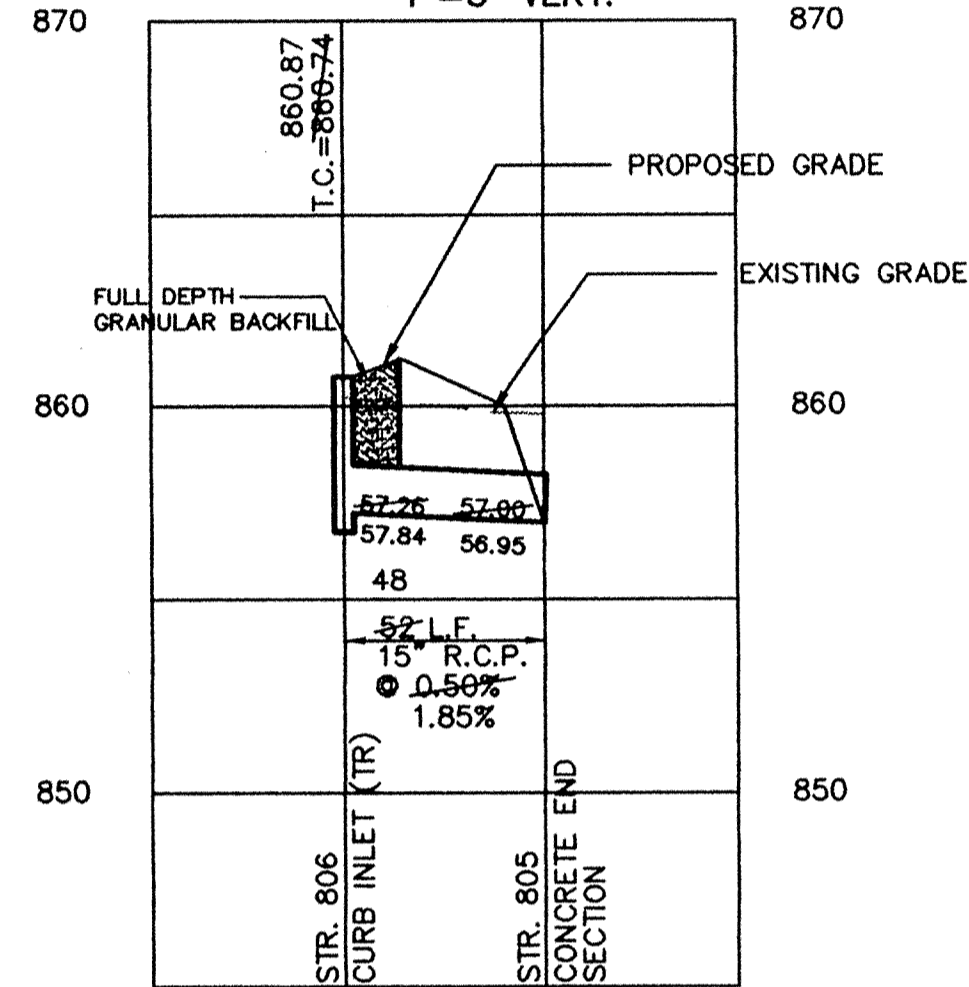

SCALE: 1"=50' HOR.
 1"=5' VERT.

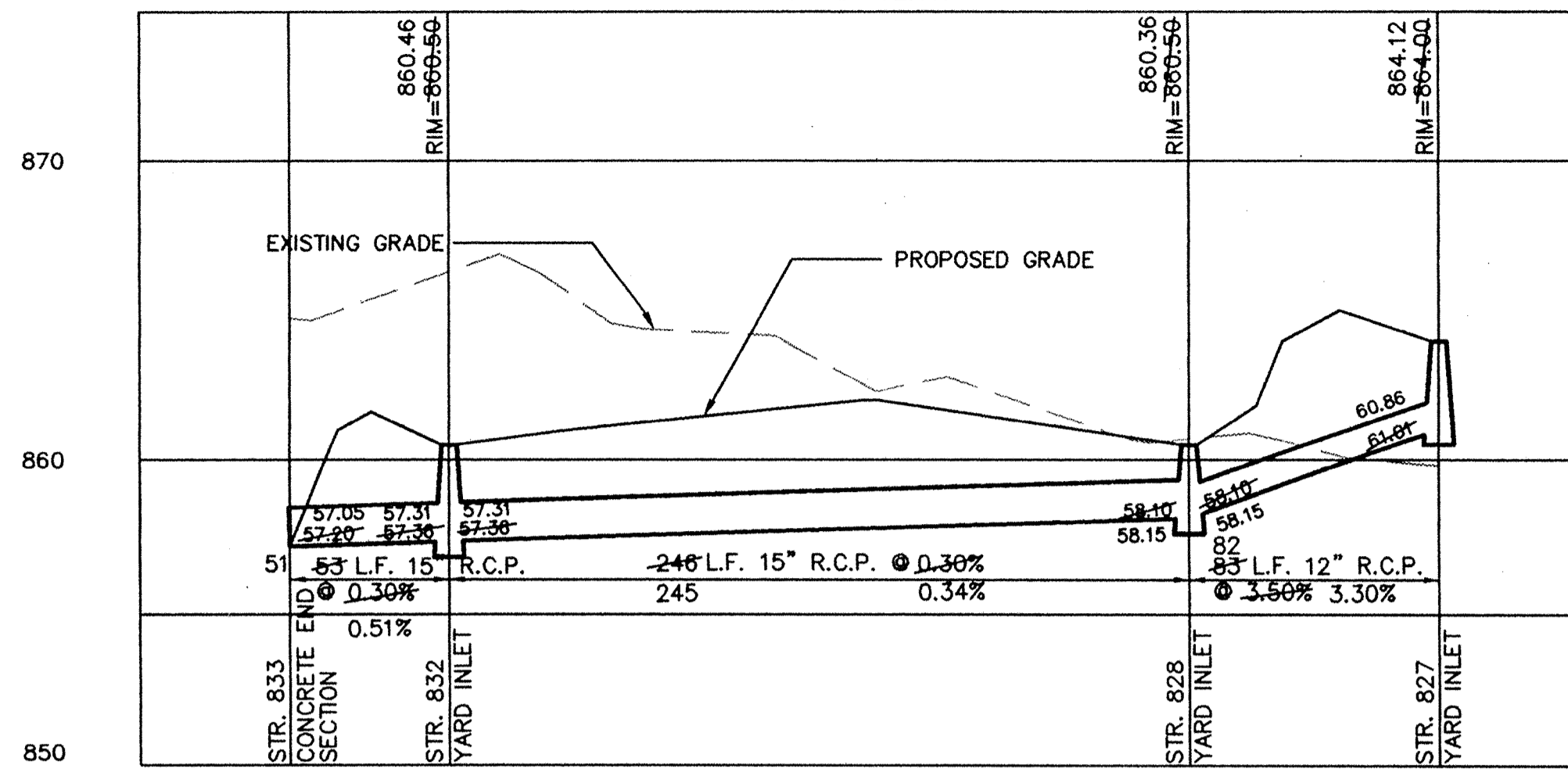
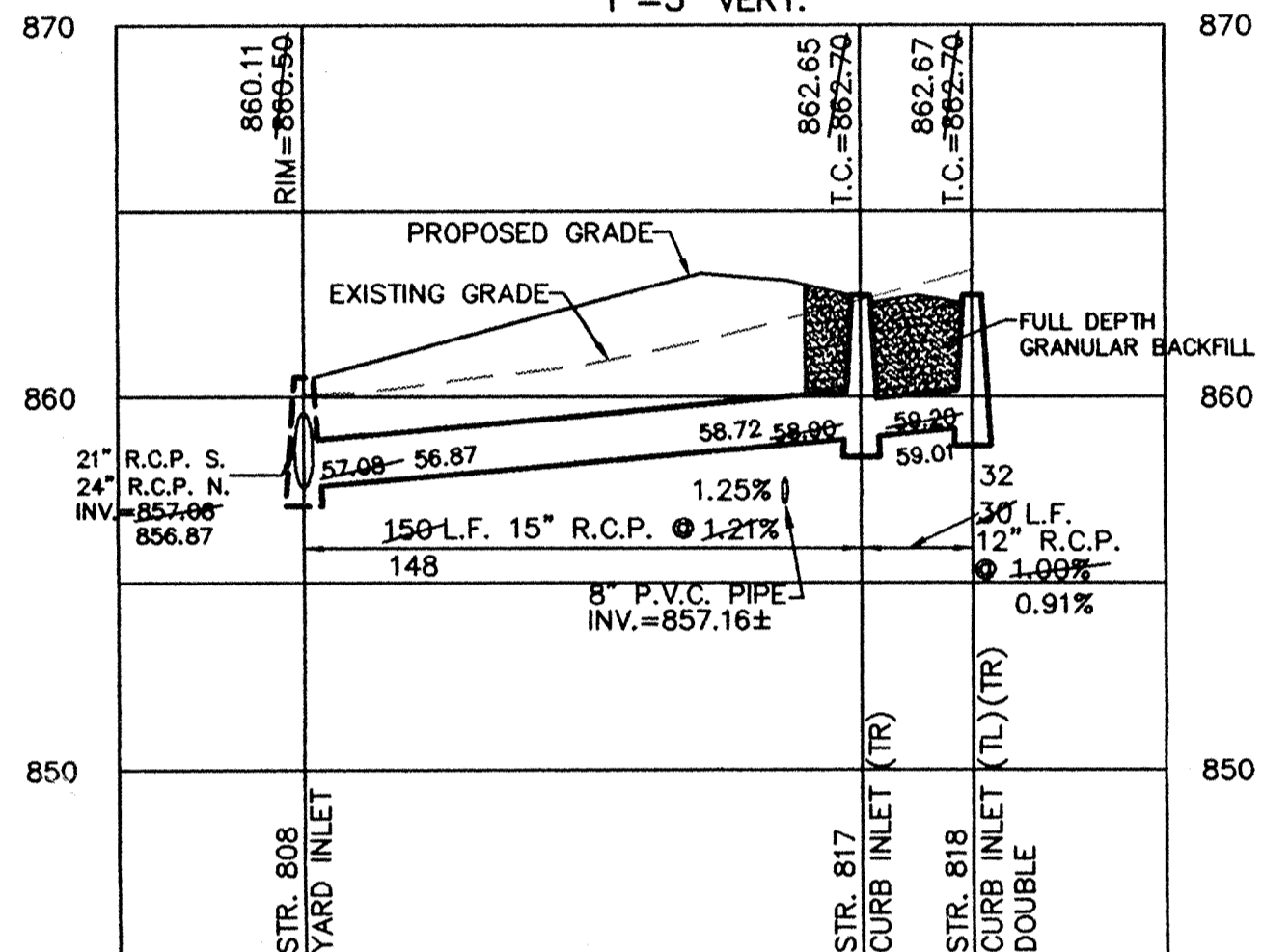

SCALE: 1"=50' HOR.
 1"=5' VERT.

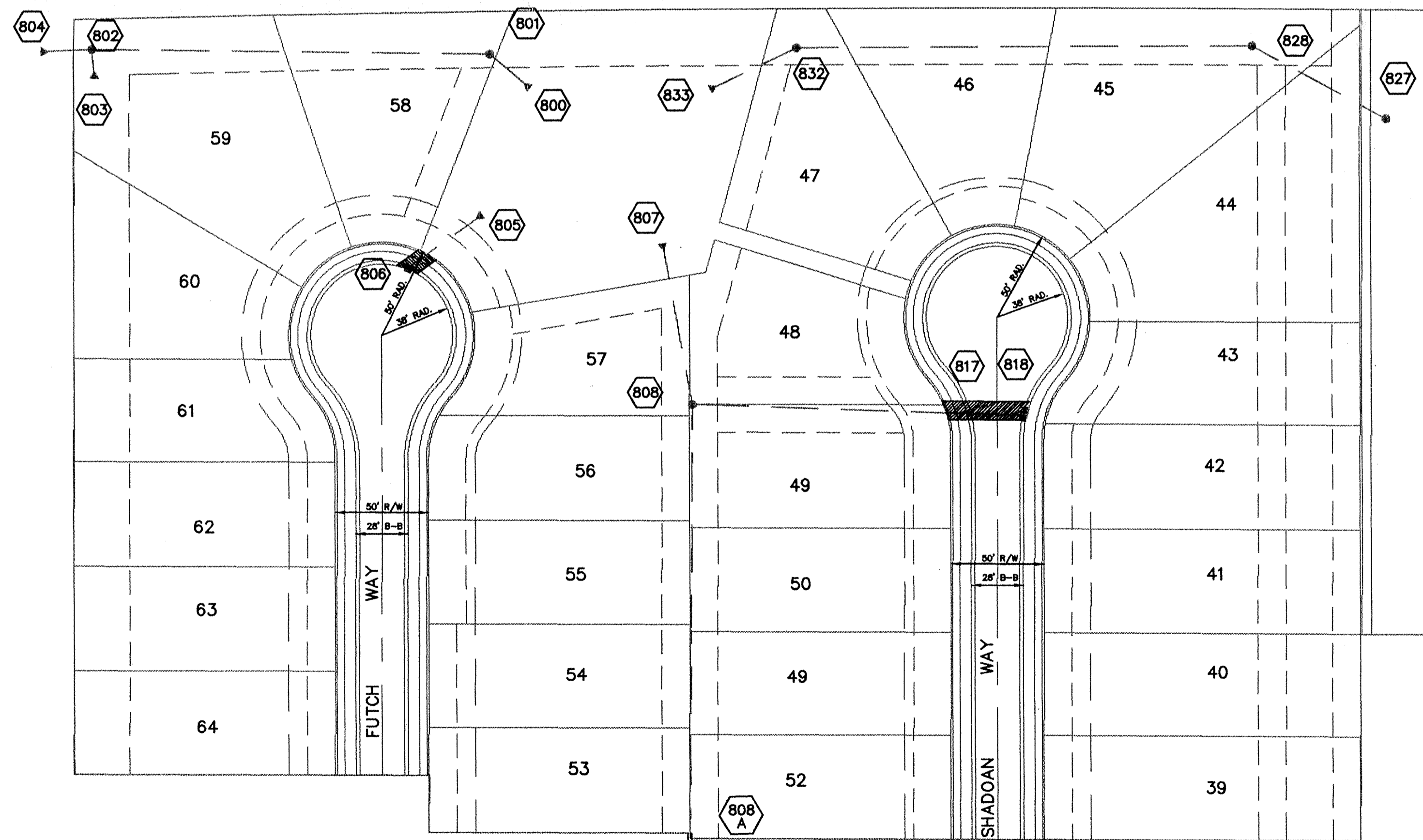
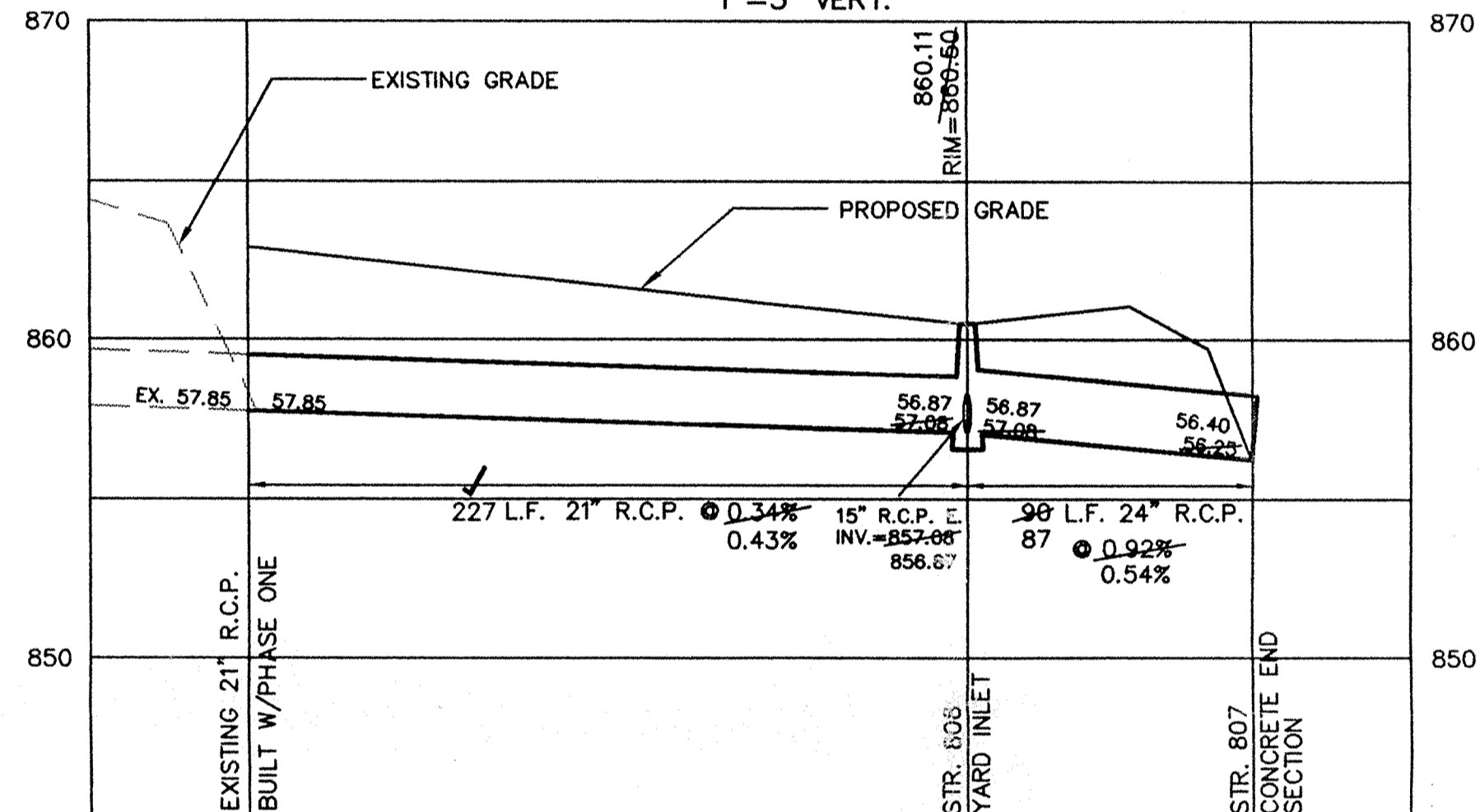

SCALE: 1"= 50'

This information was gathered for input into the Hamilton County Geographical Information System. This document is considered an official record of the GIS.
 Entry Date: 11-6-03
 Entered by: JDH

SCALE: 1"=50' HOR.
 1"=5' VERT.

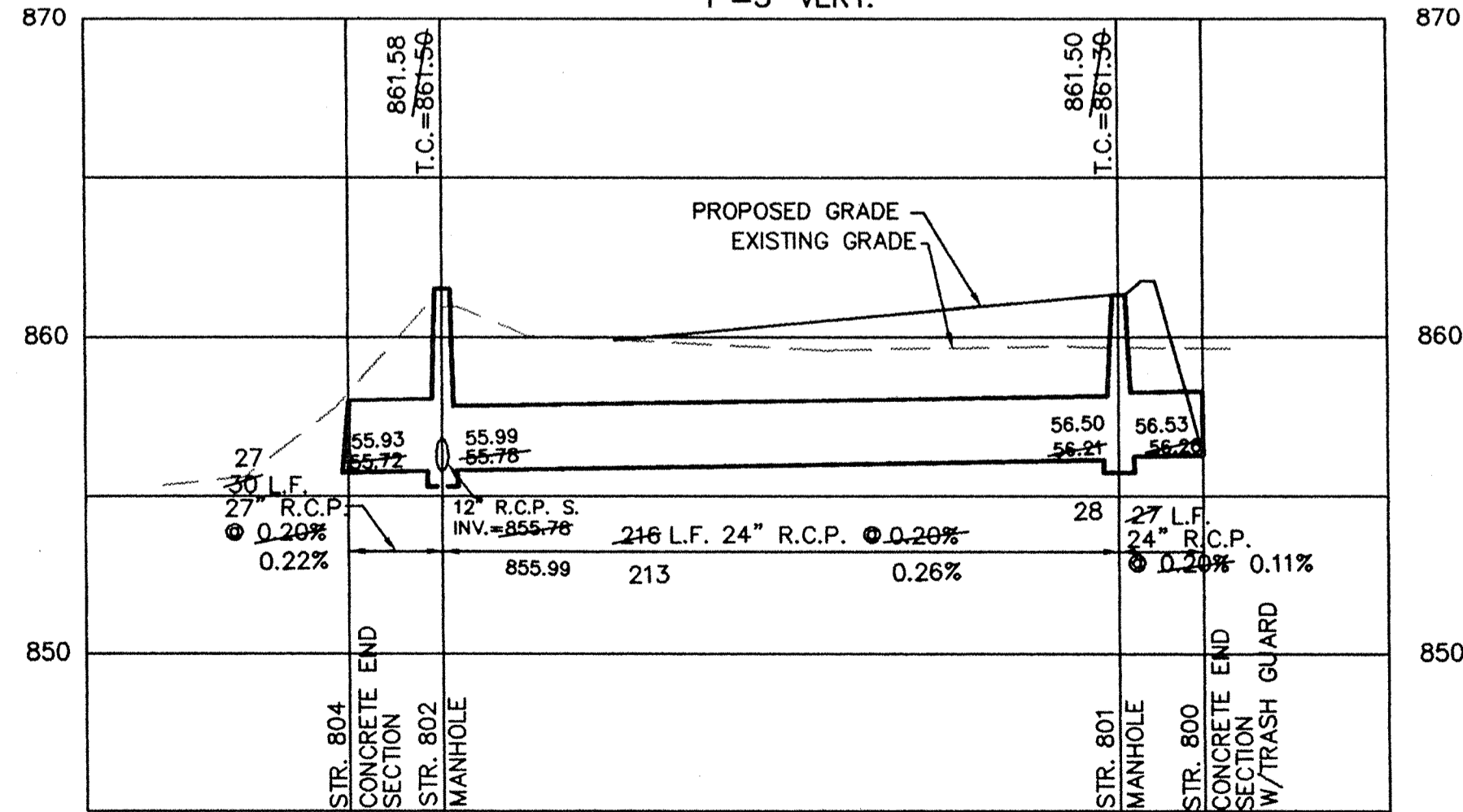

SCALE: 1"=50' HOR.
 1"=5' VERT.

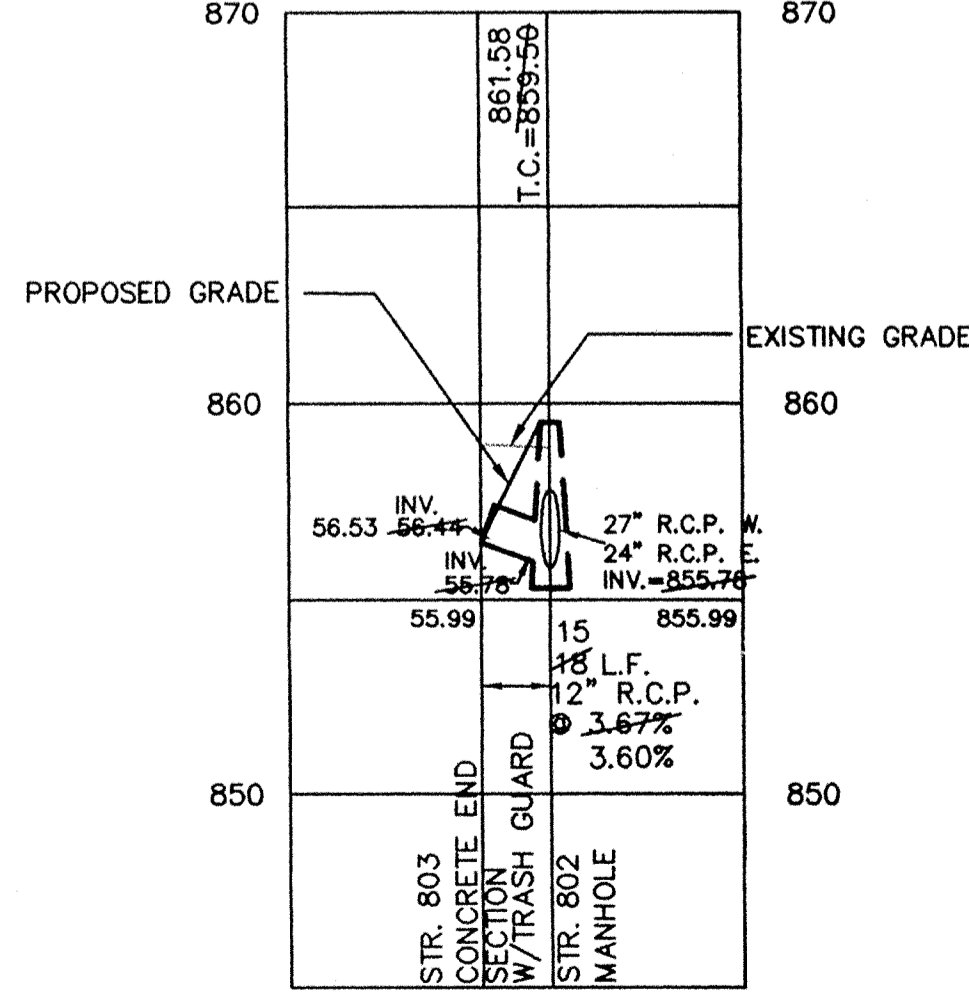

EXISTING CAREY COMMONS PHASE ONE

CONSULTING ENGINEERS - LAND SURVEYORS
 (317) 849-5935 1-800-728-6917 FAX: (317) 849-5942
 INDIANAPOLIS INDIANA



STORM SEWER PLAN & PROFILE
 CAREY COMMONS PHASE TWO
 WESTFIELD INDIANA

FILED
 SEP 24 1999
 OFFICE OF HAMILTON COUNTY SURVEYOR

SHEET NO. 9
 OF 17 SHEETS
 JOB NO. 28472

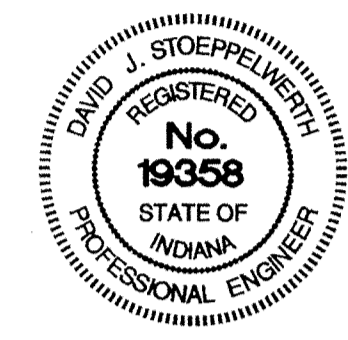
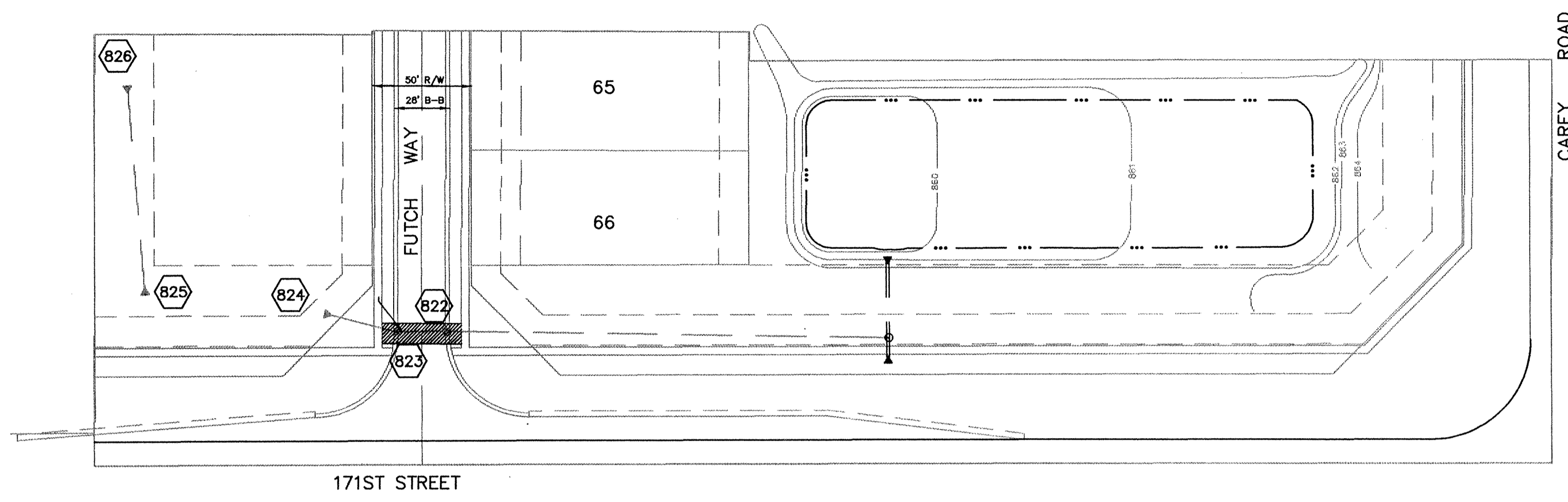

RECORD DRAWING

Jeffery W. Darling
 JEFFERY W. DARLING
 Registered Land Surveyor
 No. 900017

9/13/99
 DATE



SCALE: 1" = 50'

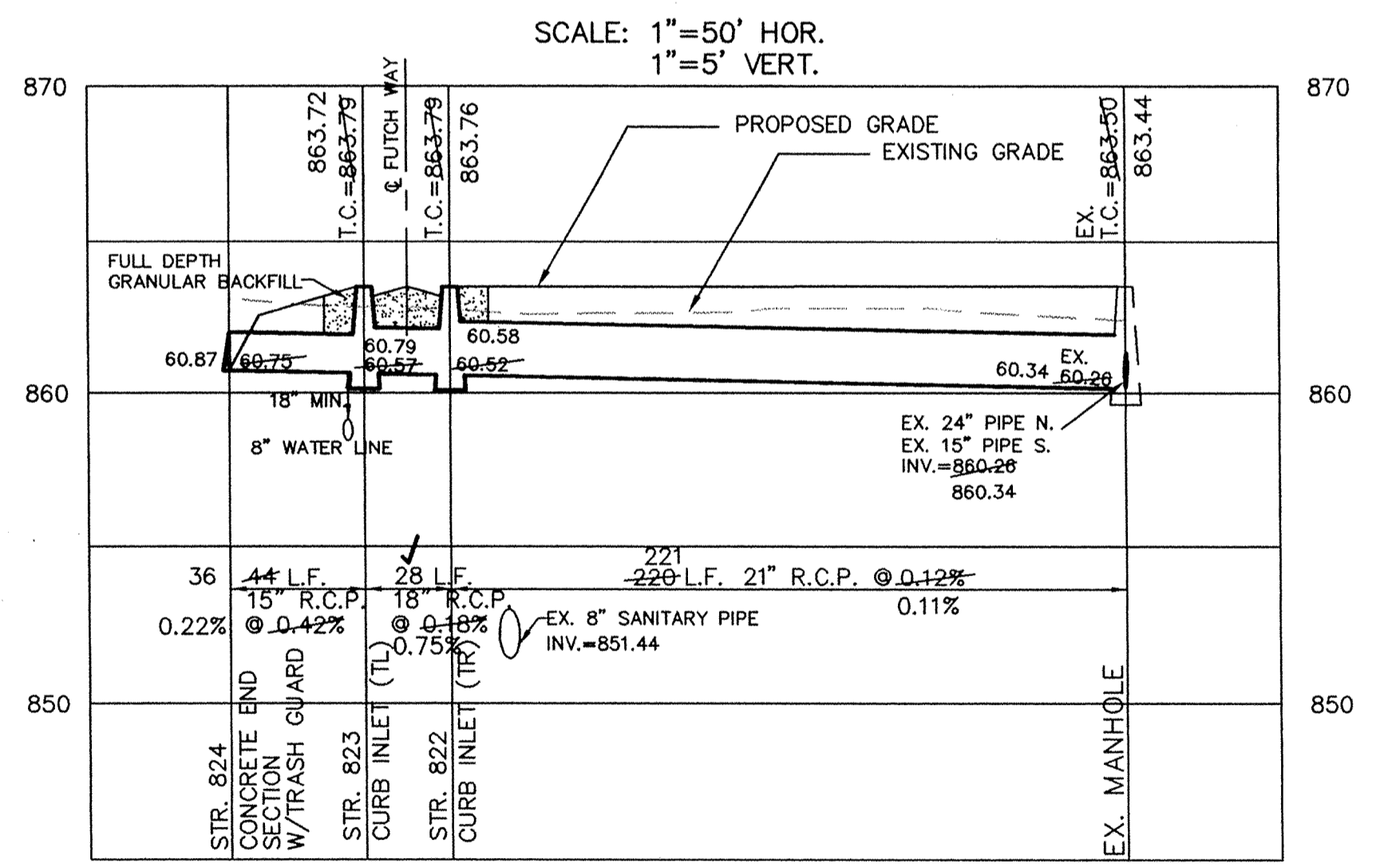
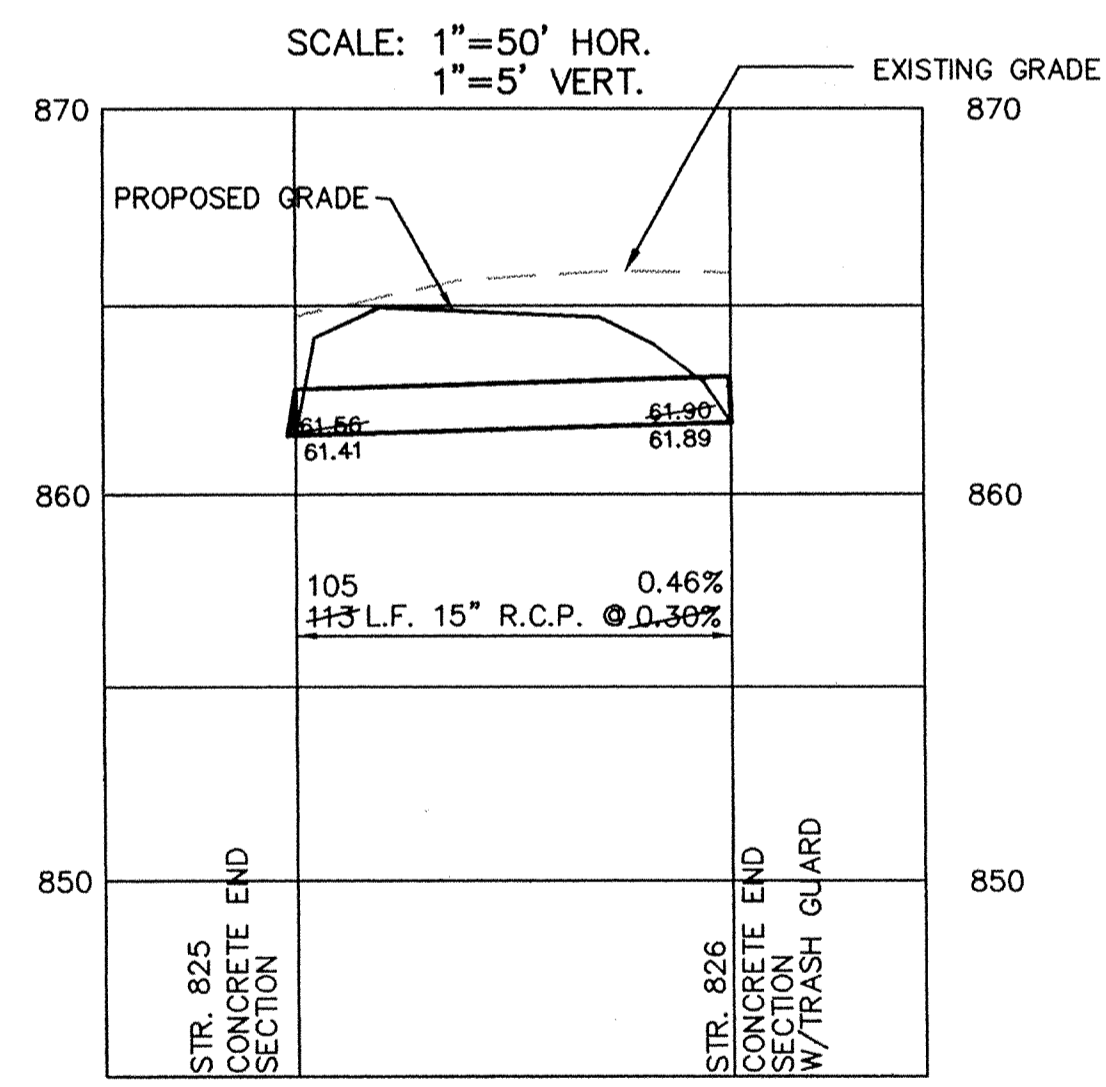

 This information was gathered for input into the Hamilton County Geographical Information System. This document is considered an official record of the GIS.
 Entry Date: 11-6-03
 Entered by: JDH

FILED
 SEP 24 1999
 OFFICE OF HAMILTON COUNTY SURVEYOR

DATE	BY	REVISIONS
1/20/98	DAVID J. STAPPEWORTH	DATE MARK
1/20/98	DAVID J. STAPPEWORTH	DATE MARK
1/20/98	DAVID J. STAPPEWORTH	DATE MARK
1/20/98	DAVID J. STAPPEWORTH	DATE MARK
1/20/98	DAVID J. STAPPEWORTH	DATE MARK
1/20/98	DAVID J. STAPPEWORTH	DATE MARK

CERTIFIED: 1/20/98

David J. Stappeworth
 REGISTERED PROFESSIONAL ENGINEER
 No. 19358
 STATE OF INDIANA

CONSULTING ENGINEERS - LAND SURVEYORS
 (317) 849-5935 1-800-728-6917 FAX: (317) 849-5942
 INDIANAPOLIS INDIANA

STORM SEWER PLAN & PROFILE
 CAREY COMMONS PHASE TWO
 WESTFIELD INDIANA

SHEET NO. 10
 17 SHEETS
 JOB NO. 28472

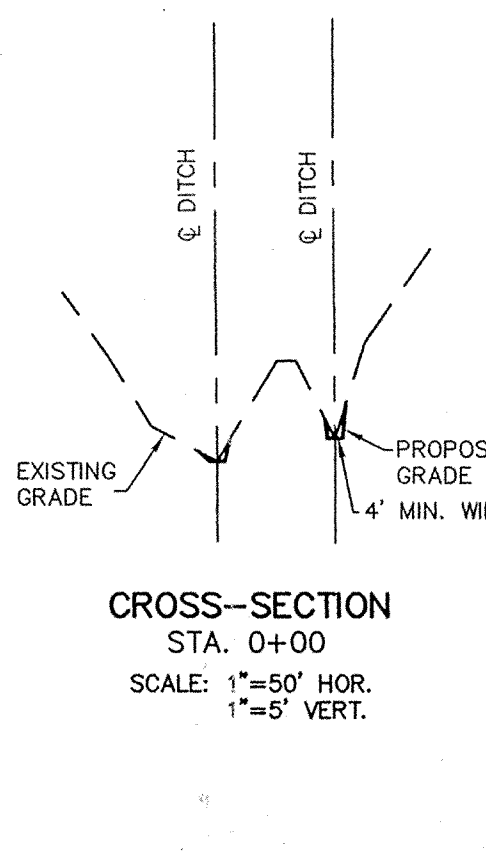
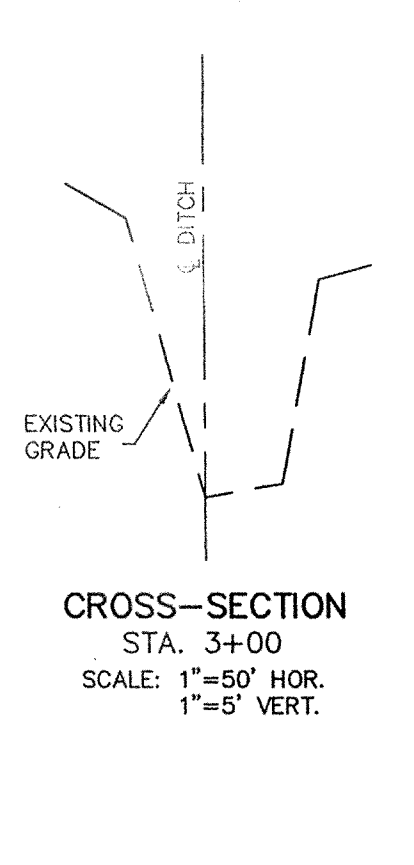
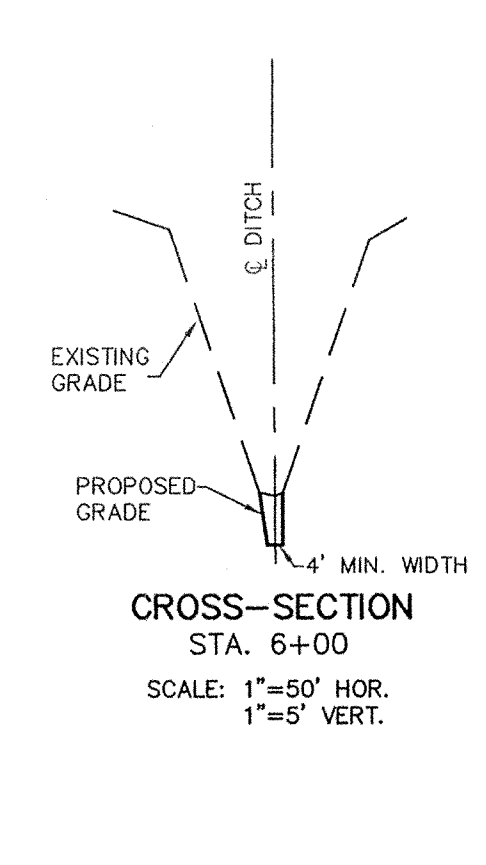
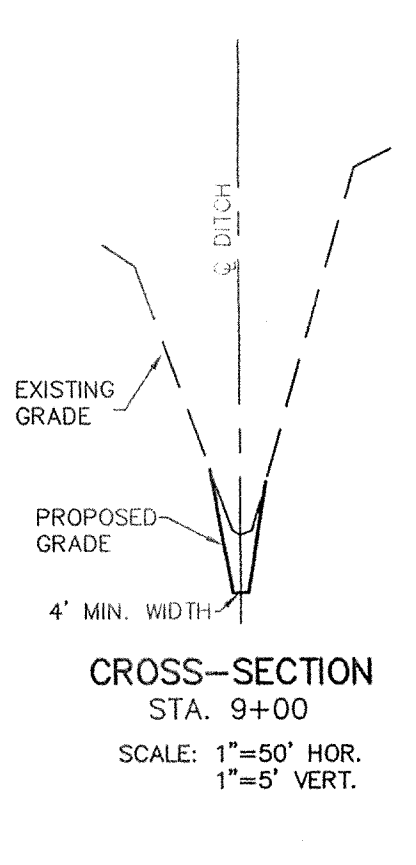
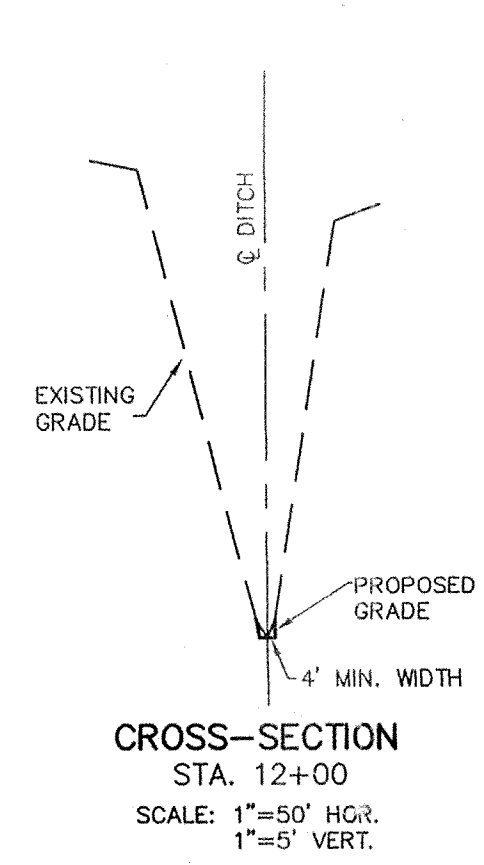
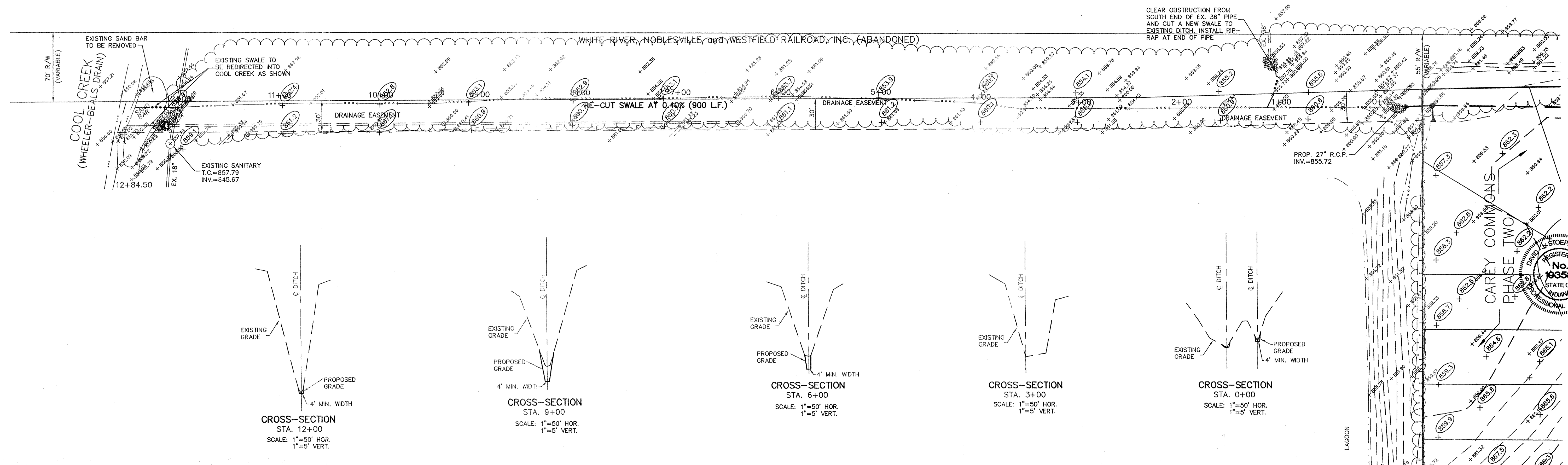

This information was gathered for input into the Hamilton County Geographical Information System. This document is considered an official record of the GIS.

Entry Date: 11-6-03

Entered by: JDH

"HOLEY MOLEY" SAYS:

1-800-382-5544
CALL TOLL FREE

1-800-428-5200
FOR CALLS OUTSIDE OF INDIANA

CAUTION

LOCATION OF ALL EXISTING UNDERGROUND UTILITIES SHOWN ON THIS PLAN ARE BASED UPON ABOVE GROUND EVIDENCE (including, but not limited to, manholes, inlets, valves, & marks made upon the ground by others.) AND ARE SPECULATIVE IN NATURE. THERE MAY ALSO BE OTHER EXISTING UNDERGROUND UTILITIES FOR WHICH THERE IS NO ABOVE GROUND EVIDENCE OR FOR WHICH NO ABOVE GROUND EVIDENCE WAS OBSERVED. THE EXACT LOCATIONS OF SAID EXISTING UNDERGROUND UTILITIES SHOULD BE VERIFIED BY THE CONTRACTOR PRIOR TO ANY AND ALL CONSTRUCTION.

NOTE TO CONTRACTOR:
 THE WORKING SIDE SHALL BE THE SOUTHSIDE OF DRAIN. THE CLEARING ON THE WORKING SIDE SHALL BE FROM TOP OF BANK TO SLOPE (TREES 18" OR GREATER AT BREAST HEIGHT MAY BE LEFT WITH PERMISSION OF THE SURVEYOR'S OFFICE AS LONG AS THE TREE DOESN'T INTERFERE WITH FUTURE MAINTENANCE ACCESS.) ALL TREES IN THE FLOWLINE FROM TOE OF SLOPE TO TOE OF SLOPE ARE TO BE REMOVED. ON THE NON-WORKING SIDE (NORTH) CLEAR TREES FROM A LINE MATCHING THE TOP OF BANK ON THE SOUTHSIDE DOWN TO TOE OF SLOPE.

RECORD DRAWING

Jeffrey W. Darling
 JEFFREY W. DARLING
 Registered Land Surveyor
 No. 900017

M/D/YR _____
 DATE _____

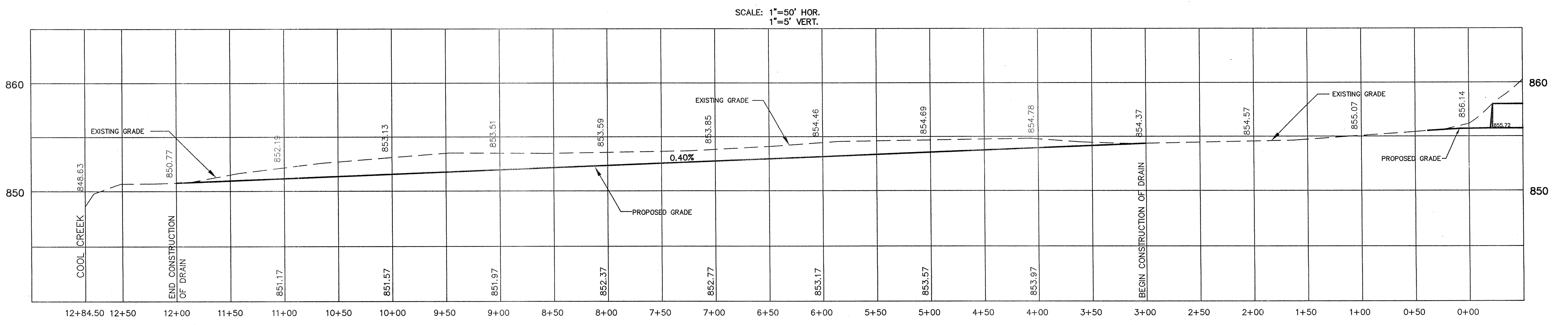
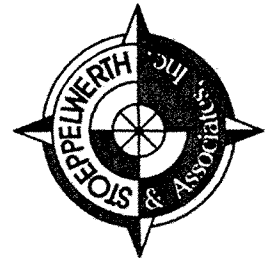

CONSULTING ENGINEERS - LAND SURVEYORS
 (317) 849-5935 1-800-728-6917 FAX: (317) 849-5942
 INDIANAPOLIS INDIANA

OFFSITE DITCH
 CAREY COMMONS PHASE TWO
 WESTFIELD INDIANA

RILED SHEET NO. 3A
 OCT 20 1999
 OFFICE OF HAMILTON COUNTY SURVEYOR
 OF 18 SHEETS
 JOB NO. 28472

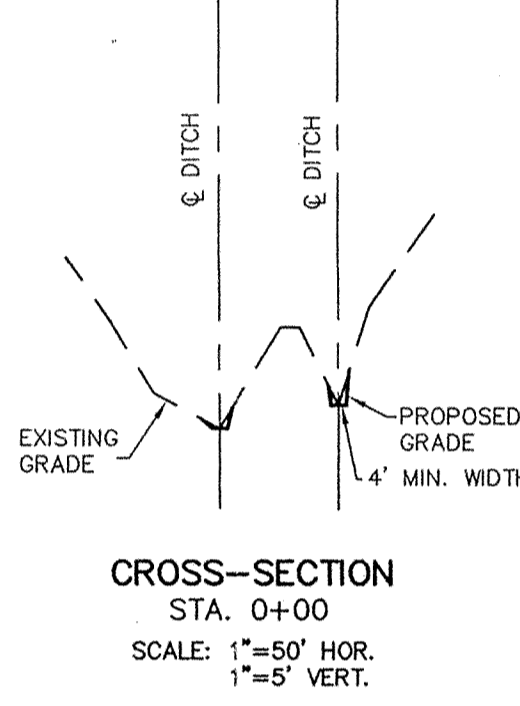
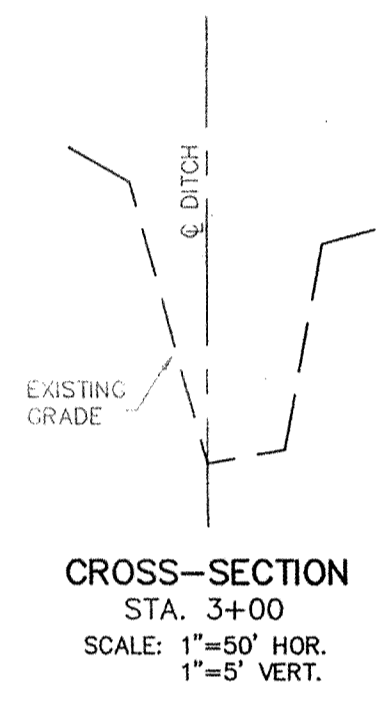
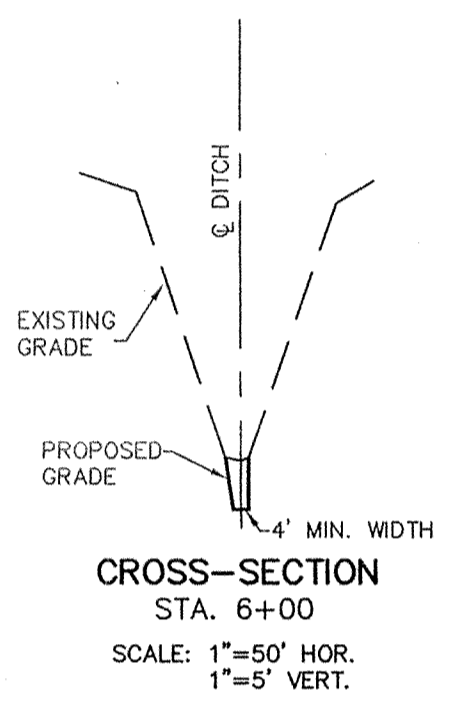
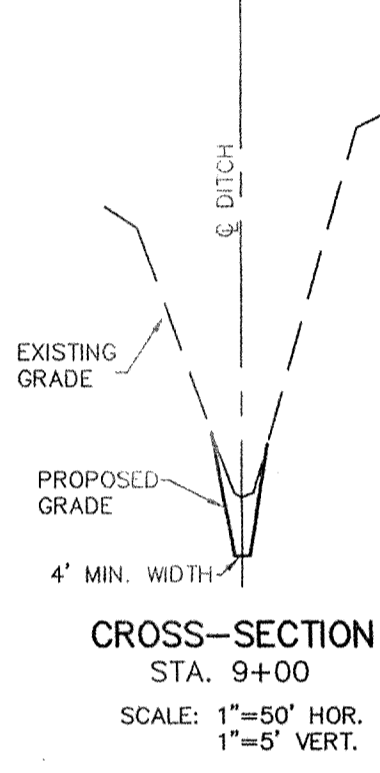
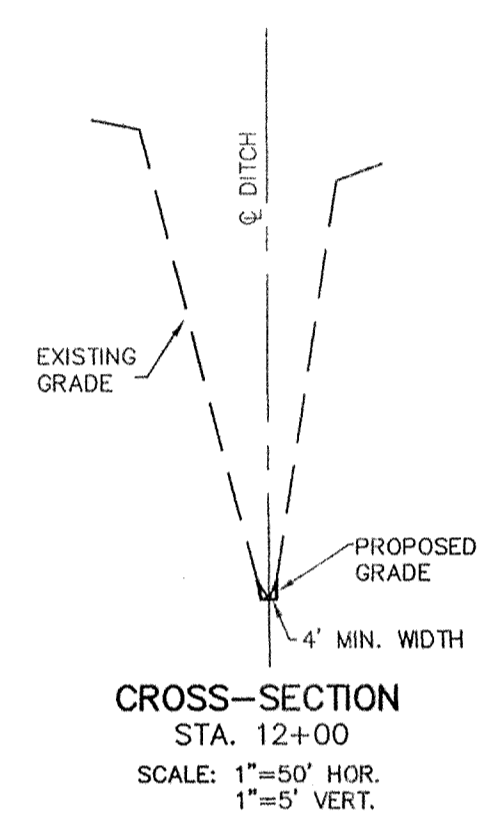
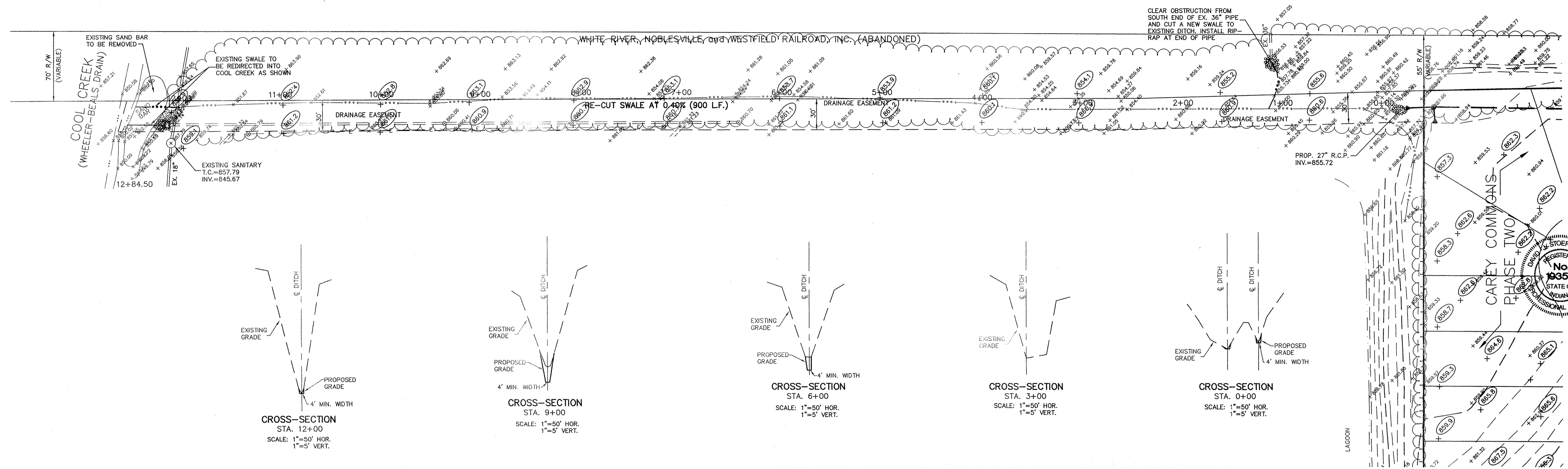

HAMILTON COUNTY INDIANA
 This information was gathered for input into the Hamilton County Geographical Information System. This document is considered an official record of the GIS.
 Entry Date: 11-6-03
 Entered by: JDH

"HOLEY MOLEY" SAYS:

 1-800-382-5544
 CALL TOLL FREE
 1-800-428-5200
 FOR CALLS OUTSIDE OF INDIANA

CAUTION
 LOCATION OF ALL EXISTING UNDERGROUND UTILITIES SHOWN ON THIS PLAN ARE BASED UPON ABOVE GROUND EVIDENCE, (including, but not limited to, manholes, inlets, valves, & marks made upon the ground by others.) AND ARE SPECULATIVE IN NATURE. THERE MAY ALSO BE OTHER EXISTING UNDERGROUND UTILITIES FOR WHICH THERE IS NO ABOVE GROUND EVIDENCE OR FOR WHICH NO ABOVE GROUND EVIDENCE WAS OBSERVED. THE EXACT LOCATIONS OF SAID EXISTING UNDERGROUND UTILITIES SHOULD BE VERIFIED BY THE CONTRACTOR PRIOR TO ANY AND ALL CONSTRUCTION.

NOTE TO CONTRACTOR:
 THE WORKING SIDE SHALL BE THE SOUTHSIDE OF DRAIN. THE CLEARING ON THE WORKING SIDE SHALL BE FROM TOP OF BANK TO SLOPE (TREES 18" OR GREATER AT BREAST HEIGHT MAY BE LEFT WITH PERMISSION OF THE SURVEYOR'S OFFICE AS LONG AS THE TREE DOESN'T INTERFERE WITH FUTURE MAINTENANCE ACCESS.) ALL TREES IN THE FLOWLINE FROM TOE OF SLOPE TO TOE OF SLOPE ARE TO BE REMOVED. ON THE NON-WORKING SIDE (NORTH) CLEAR TREES FROM A LINE MATCHING THE TOP OF BANK ON THE SOUTHSIDE DOWN TO TOE OF SLOPE.

RECORD DRAWING

Jeffrey W. Darling
 JEFFREY W. DARLING
 Registered Land Surveyor
 No. 900017

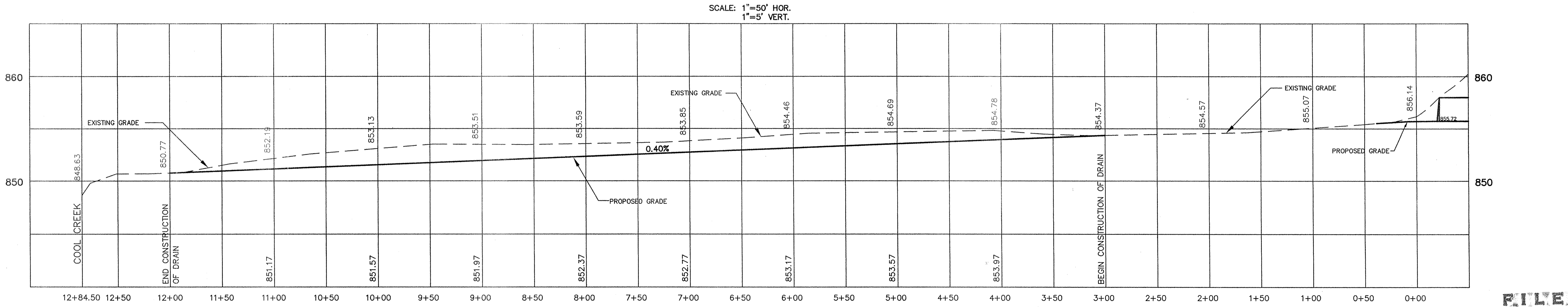

RILED
 OCT 20 1999
 OFFICE OF HAMILTON COUNTY SURVEYOR

DATE	3/12/99	BY	
SCALE	1"=50'	MARK	
DATE	3/20/99	REVISIONS	
DATE		REVISIONS	

CONSULTING ENGINEERS — LAND SURVEYORS
 (317) 849-5935 1-800-728-6917 FAX (317) 849-5942
 INDIANAPOLIS INDIANA

David J. Stoppelbech
 David J. Stoppelbech
 REGISTERED PROFESSIONAL ENGINEER
 No. 19358
 STATE OF INDIANA

OFFSITE DITCH
 CAREY COMMONS PHASE TWO
 WESTFIELD INDIANA

SHEET NO. 3A
 OF 18 SHEETS
 JOB NO. 28472